

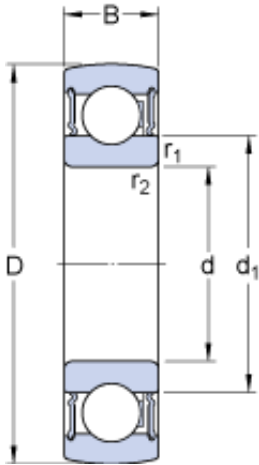

## SNR Bearing Argentina



40 mm x 80 mm x 18 mm skf 1726208-2RS1  
Insert bearings (Y-bearings)

Bearing No. 1726208-2RS1

1726208-2RS1 Bearing 2D drawings and 3D CAD models

Size	80x40x18 mm
Bore Diameter	80 mm
Outer Diameter	40 mm
Width	18 mm
d	40 mm
D	80 mm
B	18 mm
d <sub>1</sub>	52.6 mm
r <sub>1,2</sub> - min.	1.1 mm
Basic dynamic load rating - C	30.7 kN
Basic static load rating - C <sub>0</sub>	19 kN
Fatigue load limit - P <sub>u</sub>	0.8 kN
Limiting speed	5600 r/min
Calculation factor - f <sub>0</sub>	14
Category	Insert Bearings Spherical OD
Inventory	0.0
Manufacturer Name	SKF
Minimum Buy Quantity	N/A
Weight / Kilogram	0.32
Product Group	M06110
Inner Race Profile	Standard Inner Ring
Outer Race Profile	Spherical
Relubricatable	No



## SNR Bearing Argentina

Seal Type	RS1 Seal
Mounting Method	Shaft Mount
Rolling Element	Ball Bearing
Snap Ring	No
Long Description	40MM Bore; Standard Inner Ring; Ball Bearing; 18MM Length Thru Bore; 18MM Outer Race Width; 80MM Outside Diameter; Not Relubricatable; RS1 Seal Seal; Shaft Mount Mounting Method; No Snap Ring
Inch - Metric	Metric
Other Features	Single Row   Standard Duty   Metric
Category	Insert Bearings
UNSPSC	31171536
Harmonized Tariff Code	8482.10.50.00
Noun	Bearing
Keyword String	Insert
Manufacturer URL	<a href="http://www.skf.com">http://www.skf.com</a>
Manufacturer Item Number	1726208-2RS1
Weight / LBS	0.706
Outer Race Width	0.709 Inch   18 Millimeter
Length Thru Bore	0.709 Inch   18 Millimeter
Outside Diameter	3.15 Inch   80 Millimeter
Bore	1.575 Inch   40 Millimeter
bore diameter:	40 mm
radial static load capacity:	19 kN
outside diameter:	3.1496 in
finish/coating:	Uncoated
outer ring width:	18 mm
maximum rpm:	5600 RPM
bore type:	Round
seal type:	Contact/Lip



## SNR Bearing Argentina

operating temperature range:	-40 to +210 ° F
series:	17262
radial dynamic load capacity:	30.7 kN
$d_1$	52.6 mm
$r_{1,2}$ min.	1.1 mm
Basic dynamic load rating C	30.7 kN
Basic static load rating $C_0$	19 kN
Fatigue load limit $P_u$	0.8 kN
Limiting speed <sup>1)</sup>	5600 r/min
Calculation factor $f_0$	14
Mass complete bearing	0.35 kg